



LANDSCAPE TARP SYSTEMS

INSTALLATION INSTRUCTIONS



LANDSCAPE INSTALLATION

Congratulations on your purchase of a Mountain Tarp Landscape tarping system. With tarping systems for dump bodies, transfer trailers, scrap trailers, landscaping trucks and roll-offs, Mountain Tarp offers the most complete line of tarping systems and parts in the industry.

Note:

Please read through instructions for entire system and follow instructions thoroughly to ensure your system will work properly. It is important that you inspect your trailer and prepare it for installation by removing any sharp edges or anything that will cause damage to your tarp.

For further technical assistance, contact our corporate headquarters at (800) 248-7717 or email us at sales@mountaintarp.com. For parts and service, visit us at one of our locations in Kentucky or Ohio, or contact one of our many dealers nationwide. To learn more about Mountain Tarp and the products we offer, visit us online at www.mountaintarp.com.

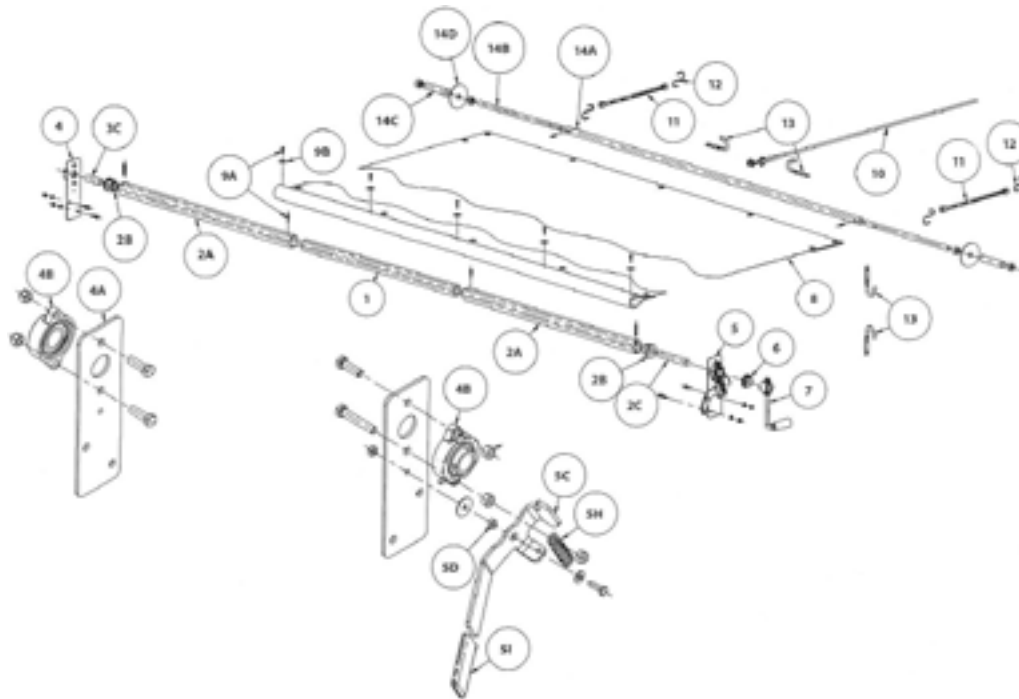

Item	Description	Item	Description	Item	Description
1	Inner Hex Tube	5	Detent Bearing Bracket Assembly	11	15" Rubber Tarp Stop
2	Driver's Side Roller Tube Assembly	5C	Detent Lever	12	S-Hook for Tarp Stop
2A	Outer Hex Tube	5D	Spacer Busher	13	Hook for Rope
2B	Shaft Adaptor	5H	Extension Spring	14	Rear Bar Kit (Optional)
2C	Crank End Shaft	5I	Detent Lever Grip	14A	Center Tube for Rear Bar Kit
3	Passenger's Side Roller Tube Assembly	6	12-Tooth Sprocket	14B	Outer Bar for Rear Bar Kit
3C	Idler End Shaft	7	Crank Handle Assembly	14C	PVC Roller Tube for Rear Bar Kit
4	Bearing Bracket Assembly	8	Tarp	14D	Guide Washer for Rear Bar Kit
4A	Tarp Roller Mount Bracket	9	Tarp Roller Kit Hardware Bag		
4B	1" Self-Aligning Bearing	10	20" Pull Rope Assembly		

LANDSCAPE INSTALLATION

STEP 1: INSTALLING TARP ROLLER ASSEMBLY

1A:
Begin by determining the location of the tarp roller. The tarp roller should be mounted above the cab on the dump body's cab guard. To prevent damage from loads being dumped into the body, the tarp roller should be mounted outside of the dump body's load area (note: verify the location is accessible for winding up the tarp).

1B:
Clamp the bearing bracket assemblies (item 4 and 5 in figure 1) to the dump body in the locations determined by step 1A. The bearing bracket assembly with the detent lever (item 5 in figure 1) is to be mounted on the driver's side of the dump body. Make sure the brackets are aligned vertically as well as from front-to-back by measuring from a common point on each side of the body. Verify the bearing bracket assemblies are mounted high enough to accommodate the tarp when rolled onto the roller bar assembly.

1C:
Mark the bearing bracket mounting hole's locations on each side of the dump body. Remove the brackets and drill 13/32" holes in the four marked locations. Attach the bearing brackets to the dump body using the four 3/8-16 x 1 cap screws, lock washers, and nuts supplied. Do not tighten fasteners at this time, just hand tighten to hold brackets in position.

1D:
Locate the inner hex tube (item 1 in figure 1) and make a pencil mark in the center of the tube's length. Insert the inner hex tube halfway into the driver's side roller tube assembly (item 2 in figure 1). Insert the passenger's side roller tube assembly (item 3 in figure 1) onto the opposite end of the inner hex tube. Measure the distance between the inside of the mounted bearing brackets. Separate the roller tubes so the length of the complete roller tube assembly from adaptor to adaptor is 1/4" less than the distance between mount brackets. Locate the pencil mark and verify that the inner hex tube is centered inside the outer roller tube assemblies. Screw each roller tube assembly to the inner hex tube using one 1/4" x 1" self drilling and tapping screw 2" from the end of the outer tube.

STEP 2: INSTALLING THE TARP

2A:
Slide the complete roll tube assembly onto the web in the end of the tarp. Verify that the webbing in the seams of the tarp will be on the bottom when installed (note: the roll tube end of the tarp has only one row of webbing reinforcement). Center the roller tube assembly on the tarp. Then hold the tarp onto the roller tube assembly and screw in place with five evenly spaced 1/4" x 1" self-drilling tapping screws and fender washers. Make sure the screws are centered in the hex tube and the screws on each end are going through the tarp's webbing reinforcement.

2B:
Remove one of the bearing bracket assemblies and slide the tarp roller assembly in to the remaining bearing. Slide removed bearing bracket over shaft and reassemble to the dump body. Tighten 3/8" bracket mounting bolts at this time. Center the tarp roller assembly between the mounting brackets and tighten set screws in each bearing race.

STEP 3: INSTALLING THE CRANK HANDLE ASSEMBLY

3A:
Place sprocket (*see figure 2*) onto the 1" shaft of the driver's side roller tube assembly (*item 2 in figure 1*). With the detent lever (*see figure 2*) in the open position, slide the sprocket down the shaft until it is tight against the bearing.

3B:
Mount crank handle assembly (*item 7 in figure 1*) onto the driver's side roller tube shaft and tighten set screw(s). This shaft may be shortened if there are no obstructions that will prevent free cranking. If shaft is shortened, the cut surface should be painted to prevent premature rusting.

LANDSCAPE INSTALLATION

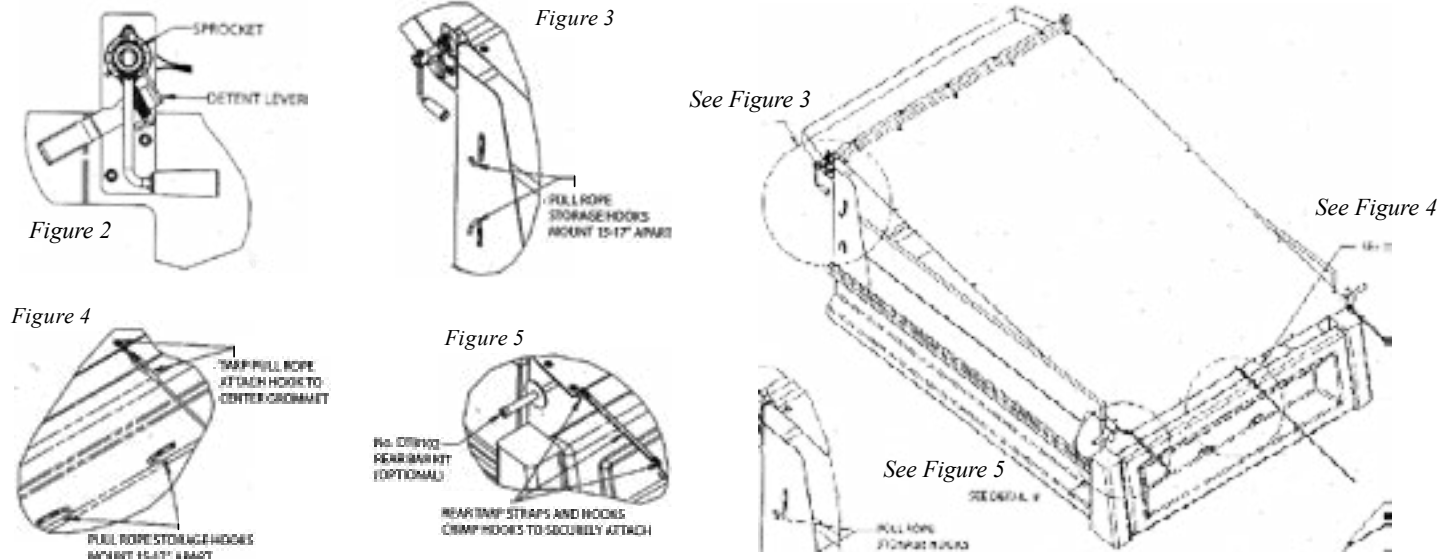

STEP 4: INSTALLING THE HOOKS AND ROPE

4A:

Attach the four s-hooks (*item 12 in figure 1*) to the two tarp straps (*item 11 in figure 1*). The small end of the s-hook is inserted into the hole in the strap and should be bent around the strap to permanently attach the hook to the strap. The two strap assemblies should be attached to the rear corner holes in the tarp. The large hooks should be bent around the tarp grommets to permanently attach the straps to the tarp (*see figure 3*).

4B:

Attach the pull rope assembly to the center grommet on the rear of the tarp (*see figure 4*). Then attach two rope storage hooks to the dump body tailgate to wrap the pull rope for storage when the tarp is covering the body. The hooks should be mounted horizontally and may be bolted (bolts not included) or welded to the dump body. The recommended distance between the hooks is 15-17" (*see figure 4*).

4C:

Attach two rope storage hooks to the side of the dump body near the crank handle assembly to wrap the pull rope for storage when the tarp is retracted. The hooks should be mounted vertically and may be bolted (bolts not included) or welded to the dump body (*see figure 5*).

STEP 4: INSTALLING THE RETENTION BOW KIT (OPTIONAL)

5A:

Attach the outer bars (*item 14B in figure 1*) to the center tube (*item 14A in figure 1*) using the two 5/16" x 1" roll pins supplied (*see item 14F in figure 1*). Then slide rear bar assembly into the pocket at the rear of the dump body tarp and center the bar in the tarp. The same amount of bar should be exposed on each side of the tarp. Assemble a lock collar, guide washer (*item 14D in figure 1*), PVC roller tube (*item 14C in figure 1*), and a second lock collar onto each end of the rear bar assembly.

5B:

Measure the inside width of the top of the dump body or bed extension boards where the guide washers will slide in between. Adjust and tighten the lock collars so that the guide washers are held 1/2" narrower than the body measurement. Make sure that the PVC roller tubes can spin freely on the rear bar. After the rear bar is adjusted to fit the body, the excess bar may be cut off to limit the amount of bar protruding outside of the dump body. If the rear bars are cut, the cut ends should be painted to prevent premature rusting.